

STORE DESIGN
5500 WAYZATA BLVD. STE 1000
MINNEAPOLIS, MN 55416
PHONE: 952.593.9943
FAX: 952.593.9787

BUFFALO WILD WINGS
LOCATED AT:
HOWARD HUGHES PROMENADE
6081 CENTER DRIVE
LOS ANGELES, CA 90045

DO NOT SCALE DRAWINGS
CONTRACTOR TO VERIFY
ALL EXISTING CONDITIONS
AND DIMENSIONS - NOTIFY
ARCHITECT OF ANY
DISCREPANCIES PRIOR TO
BEGINNING CONSTRUCTION

NO	DESCRIPTION	DATE
1	PERMIT SET	1/17/13
2	PERMIT RESUBMITTAL	3/29/13
3	PERMIT RESUBMITTAL	5/8/13

STIE PLAN
PROJECT NUMBER 47876
SHEET NUMBER A000

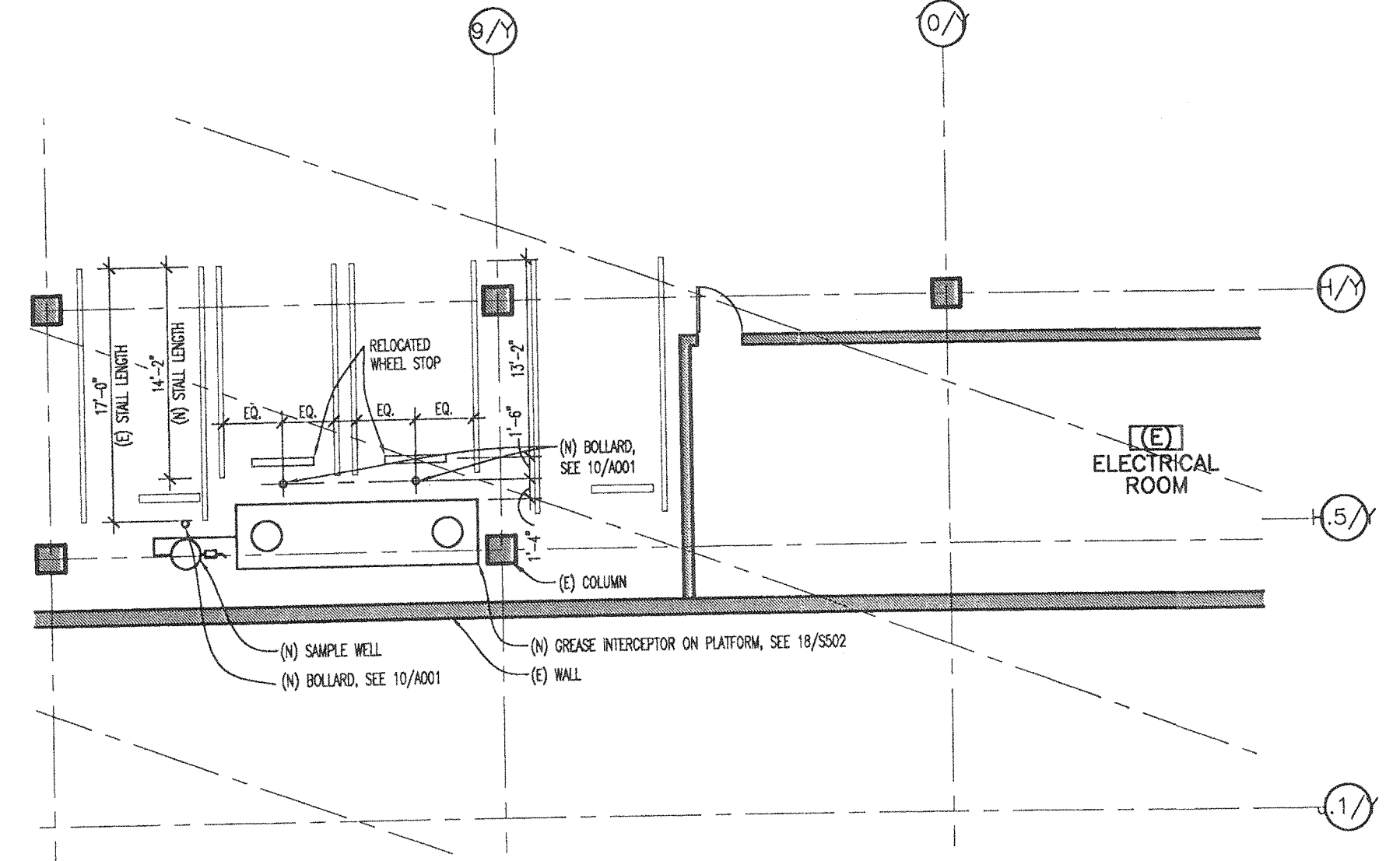

04 PARKING LEVEL G.I. LOCATION
SCALE: 1/8"=1'-0"

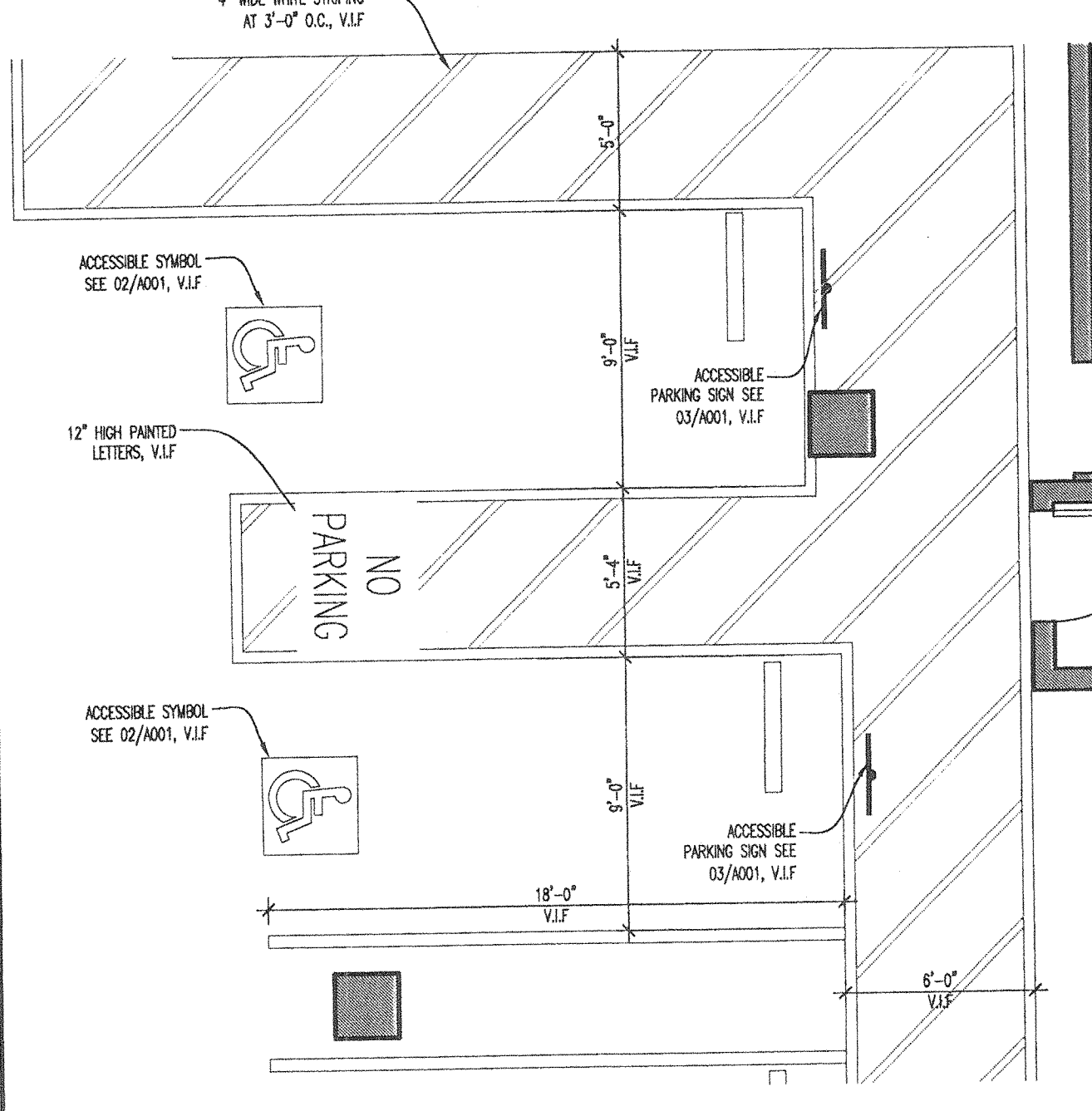

03 TYP. EXISTING ACCESSIBLE PARKING
SCALE: 1/4"=1'-0"

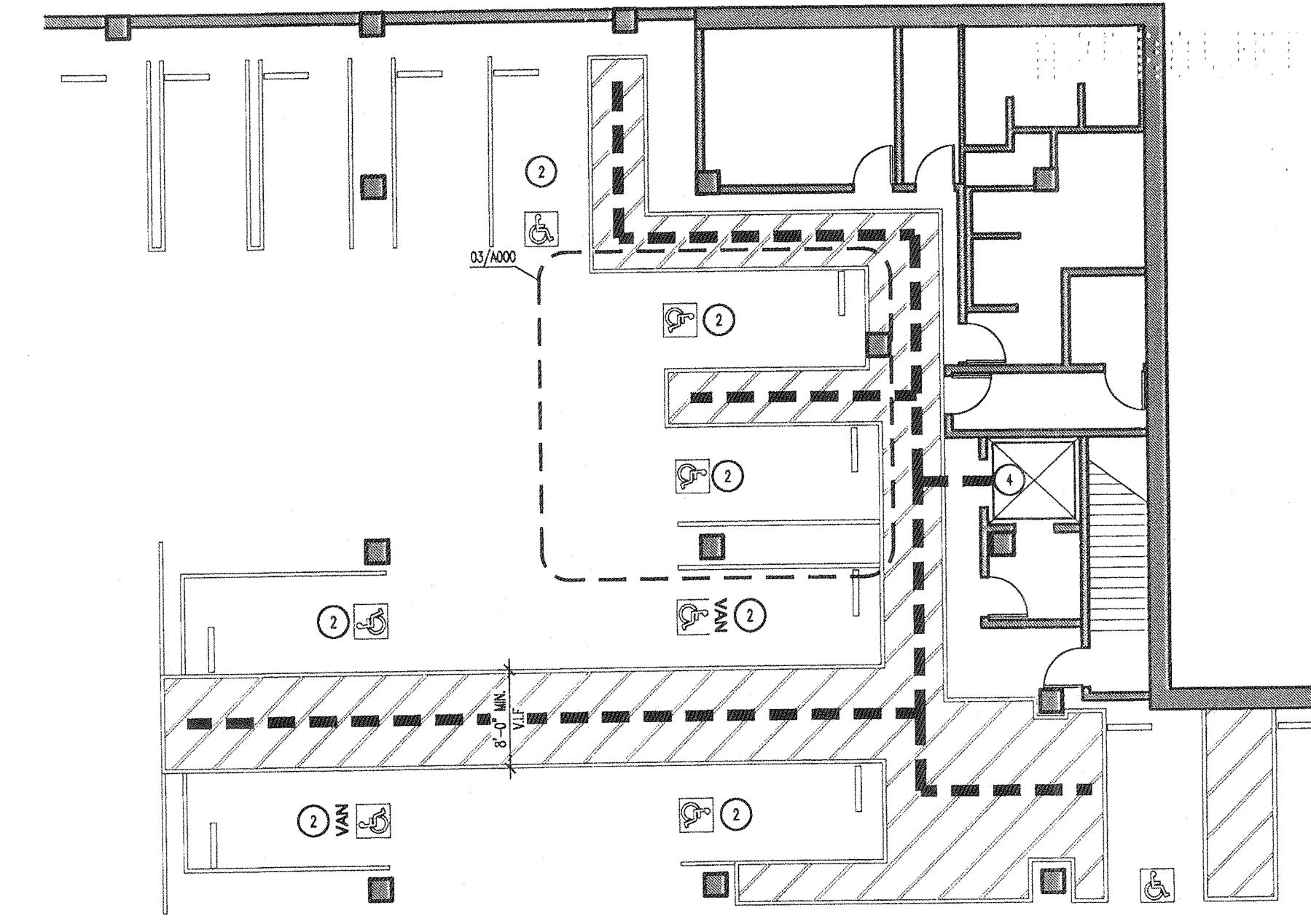

02 EXISTING ACCESSIBLE PARKING
SCALE: 1"=10'-0"

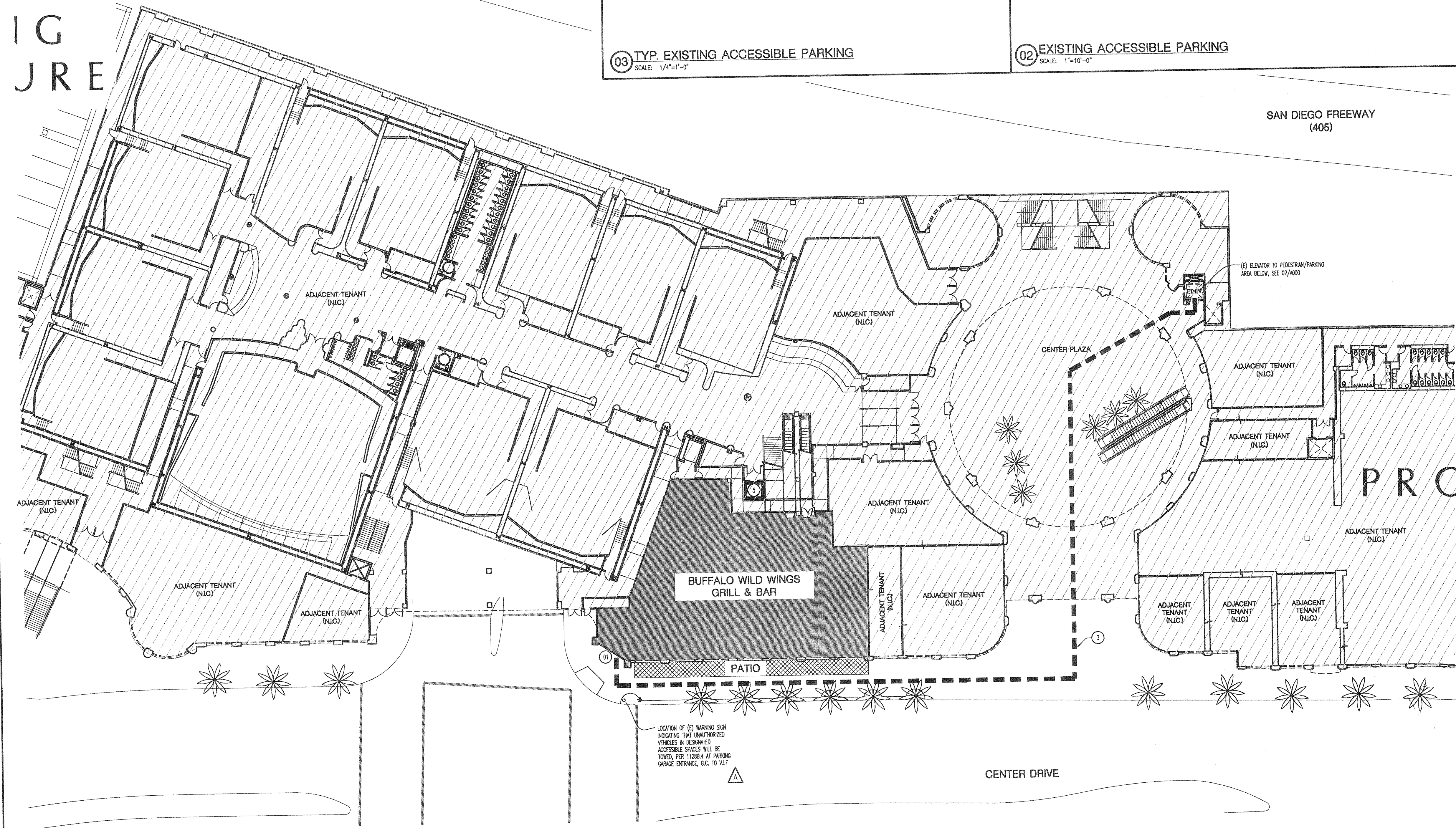

01 SITE PLAN
SCALE: 1"=20'-0"

LEGEND

- LEASE LINE
- AREA OF TENANT IMPROVEMENT
- ▨ AREA OF PATIO
- ACCESSIBLE PATH OF TRAVEL TO NEAREST ACCESSIBLE PARKING

KEY NOTES

- 1 (N) MAIN ENTRY
- 2 (E) HC PARKING SPACE, NO CHANGE
- 3 (E) ACCESSIBLE PATH TO ELEVATOR, NO CHANGE
- 4 (E) ELEVATOR TO PEDESTRIAN PLAZA ABOVE, SEE 01/A000
- 5 (E) SERVICE ELEVATOR

LOCATION OF (E) WARNING SIGN
INDICATING THAT UNAUTHORIZED
VEHICLES IN DESIGNATED
ACCESSIBLE SPACES WILL BE
TOWED, PER 11288.4 AT PARKING
GARAGE ENTRANCE, G.C. TO V.I.F.

PRINTED: 05/06/13 BY: TODD B.
DRAWING NAME: A000-47876.DWG
DATE: 5/8/13